



## **WATER-HEATER FOR VEHICLES**



- Technical description
- Installation instructions
- Operating instructions

### **Maintenance Instructions**

# Contents

- P01** Operating Principle and Use of SS4200A and SS5000A Water Heaters
- P01** Main parts of SS4200A and SS5000A water heaters
- P02** Installation Instructions and Regulations
- P02** Safety Instructions and Operation
- P04** Technical data and specifications
- P05** Heater Installation Location and Position
- P05** Engine cooling system and heater hose connection
- P06** Combustion Air System
- P06** Exhaust System
- P07** Fuel Supply
- P09** Operating Instructions
- P09** Description of Functions
- P10** Controls and Safety Device
- P10** Electrical System
- P11** Troubleshooting, Malfunctions and Maintenance
- P14** Heater Assembly Drawing SS4200A and SS5000A
- P16** Installation Components Diagram SS4200A and SS5000A



## Operating Principle and Use of SS4200A and SS5000A Water Heaters

The SS4200A and SS5000A water heaters are designed to be used as auxiliary engine heaters for trucks, RVs, boats, construction and farm equipment. In extreme cold temperatures, the heaters will keep the engine warm and also eliminate cold engine starting problems without the necessity of engines idling or frequent startups. In addition, the heater will provide heat to keep the operator cabin or sleeper berth warm and comfortable for a fraction of the cost in comparison to engine idling. Automatic controls keep the temperature of circulating water between 75°C — 80°C, (167 F — 176 F). Compact design, low volume, easy maintenance, safety protection, auto self diagnosis, optional timing, wireless remote control, low exhaust emission low operating cost make the heaters ideal to use in trucks, boats, farm and construction equipment.

## Main parts of SS4200A and SS5000A water heaters

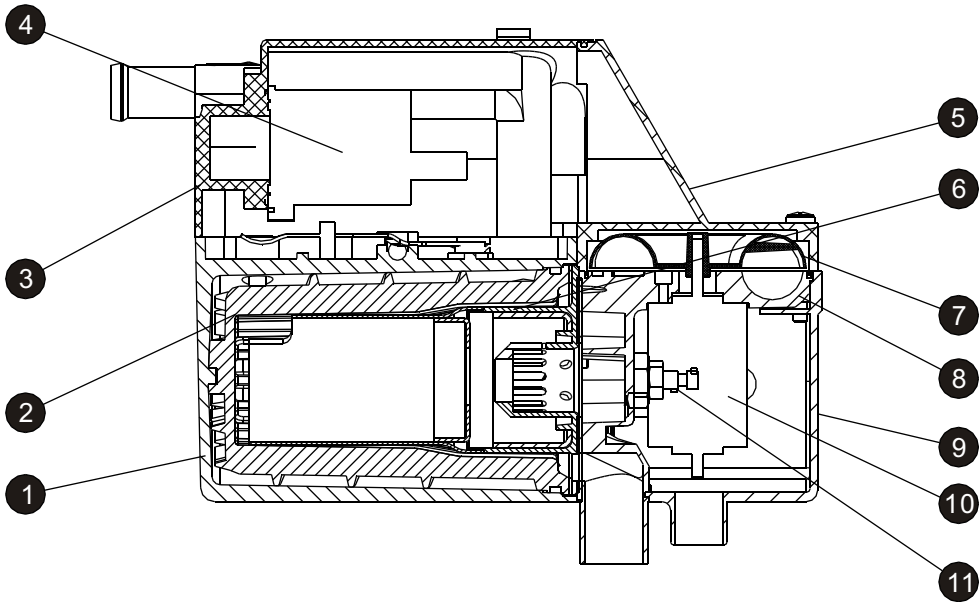

- |                            |                                   |                                  |
|----------------------------|-----------------------------------|----------------------------------|
| (1) Housing                | (5) Outer, upper cover            | (9) Outer, lower shell           |
| (2) Heat exchanger         | (6) Burner assembly               | (10) Combustion air blower motor |
| (3) Inner housing          | (7) Combustion air blower         | (11) Glow pin                    |
| (4) Water circulation pump | (8) Intake and exhaust air system |                                  |

### ◆ Operation

The fuel pump delivers fuel to the heater atomizer. The glow pin ignites the fuel-air mixture. Burning fuel heats up the heat exchanger. The heat is transferred into circulating water (coolant) through the heat exchanger, and the warm water (coolant) circulates through the engine block and the cabin heater core, keeping them warm.



# WATER-HEATER FOR VEHICLES

- Technical description
- Installation instructions
- Operating instructions
- Maintenance instructions

## ◆ Use and application

Widely used in water-cooled engines: cars, commercial and industrial equipment, trucks, passenger vans, buses, motor and sail boats, and houseboats. In addition, the heaters are used for heating water in RV's, travel trailers, cabins, watering carts, food service vehicles, and cleaning vehicles.

## Installation Instructions and Regulations

Select the location to place the heater in the engine compartment or truck cabin so that the heater exhaust gases will exhaust directly to the outside of the cabin or passengers space, through the floor or wall, and the heater water hoses can be easily attached to the cabin heater core lines. The top of the heater must be installed below the minimum engine coolant/water level to allow the air to escape and the heater to fill up with water/coolant when the bleed screw is open. Protect the heater from excessive heat, exposure, and possible contamination from fuel or oil. Keep heater exhaust away from electrical wires, fuel lines, water lines, and any other heat sensitive and flammable materials. Provide sufficient ventilation.

All precautions must be taken when arranging the heater placement to minimize the risk of injury or damage to property.

## ◆ Fuel Supply

The fuel intake connections shall NOT be in the passenger compartment or operator (driver) cabin. In vehicles where a separate fuel tank is used for the heater, the fuel tank lines and intake connection must be clearly identified. A warning sign shall be permanently attached to the intake connection or fuel tank indicating that the heater must be switched OFF before refueling.

## ◆ Exhaust System

The exhaust outlet must be arranged in a way to prevent penetration of exhaust fumes into the vehicle interior through the ventilation system, warm air intakes, or open windows, etc.

## ◆ Combustion Air Intake

The heater combustion air shall NOT be taken from passenger compartment, cargo space or operator (driver) cabin. The air intake shall be protected from possible water intake into combustion chamber, and cannot be blocked by any object at any time.

## ◆ Please Note:

• Failure to comply with the regulations, safety instructions, repairs done by unauthorized person, use of aftermarket parts voids warranty and relieves manufacture, distributors, dealers, and installation technicians from any and all liabilities.

## Safety Instructions and Operation

Disconnect vehicle battery power before commencing repair or performing heater maintenance.

Before beginning any work on the heater, switch the heater OFF and let all hot parts cool down.

The heater shall NOT be used in: poor ventilated rooms, garages, shops, multi-storage car park, etc. Use heater only in open, well ventilated areas.

Use of aftermarket parts is strictly prohibited unless authorized by the manufacturer.

Installation and operation of the heater shall comply with statutory regulations, safety instructions and specifications as stated in the installation and operating instructions. Extreme precaution shall be taken when installing and maintaining electrical wiring, fuel supply, combustion air and exhaust system.

# WATER-HEATER FOR VEHICLES



- Technical description
- Installation instructions
- Operating instructions
- Maintenance instructions

Unauthorized persons are not allowed to do any repairs or maintenance.

Debris or any other remains shall be removed and cleaned before reinstalling the heater into another vehicle.

The heater shall NOT be used in hazardous places such as but not limited to: fuel depots, carbon storage, timber warehouses, granaries and any other places where combustible or flammable vapor or dust may be present.

Heater must be switched OFF during refueling.

The heater shall be installed in a spacious compartment. Fuel canisters, oil cans, spray cans, gas cartridges, fire extinguisher, cleaning rags, clothing, papers, or any combustible or flammable materials shall NOT be stored or transported on or next to the heater.

Defective or burned fuses shall be replaced only with same type and same rating fuses.

In the event of a fuel leak; turn OFF the heater immediately, disconnect and cap off fuel line. The leak shall be repaired by a professional, authorized technician.

Use only coolant liquids that are permitted by the vehicle manufacturer. Use of other coolants might damage the engine or heater.

## ◆ Please note:

• Do NOT prematurely shut down the heater by disconnecting the power unless required to do so by an emergency.



## WARNING

• Carbon monoxide monitoring sensor with alarm shall be installed in all passenger compartments, operator or driver cabin, and sleeper berth.



# WATER-HEATER FOR VEHICLES

• Technical description • Installation instructions • Operating instructions • Maintenance instructions

## Technical data and specifications

Model		HYDTEC ® SS4200A		HYDTEC ® SS5000A	
Heating medium		Water, coolant		Water, coolant	
Heat flow control		High	Low	High	Low
Heating output (kw)		14,400 (4.2)	7,500 (2.2)	17,060 (5)	7,500 (2.2)
Fuel consumption (L/h)		0.13 (0.51)	0.06 (0.25)	0.16 (0.61)	0.06 (0.25)
Fuel		Diesel			
Power consumption(W)	Operating	53 w	27 w	53 w	27 w
	Startup	120 w		120 w	
Rated voltage(V)		12 or 24		12 or 24	
Operating voltage range	Minimum voltage	10.2 V or 21V (under-voltage protection will shutdown the units when the voltage drops to this value)			
	Maximum voltage	16 V or 32V (over-voltage protection will shutdown the units when the voltage riches this value)			
Allowable operation pressure		Max. 15PSI (1 bar)			
Water capacity of the heater		0.046 gal. (0.175 L)			
Water through-put capacity		225~265 US Gal/h 850~1000 L/h (approx operational pressure 10Kpa )			
Minimum water through-put capacity		63.50 US Gal/h (240 L/h)			
		Operating	Shutdown	Operating	Shutdown
Allowable ambient temperature	Heater	-40℃~ 80℃ -40°F ~ 176°F	-40℃~ 105℃ -40°F ~ 221°F	-40℃~ 80℃ -40°F ~ 176°F	-40℃~ 105℃ -40°F ~ 221°F
	Fuel pump	-40℃~ 80℃ -40°F ~ 176°F	-40℃~ 105℃ -40°F ~ 221°F	-40℃~ 80℃ -40°F ~ 176°F	-40℃~ 105℃ -40°F ~ 221°F
	Controller	-40℃~ 80℃ -40°F ~ 176°F	-40℃~ 105℃ -40°F ~ 221°F	-40℃~ 80℃ -40°F ~ 176°F	-40℃~ 105℃ -40°F ~ 221°F
Weight (excluding heating medium and optional etc)		Approx. 3.1 Kg / Approx. 6.8 Lbs		Approx. 3.1Kg / Approx. 6.8 Lbs	

◆ **Please note:** • Listed technical data is subject to the tolerances of  $\pm 10\%$ .

### ◆ Heater Dimensions

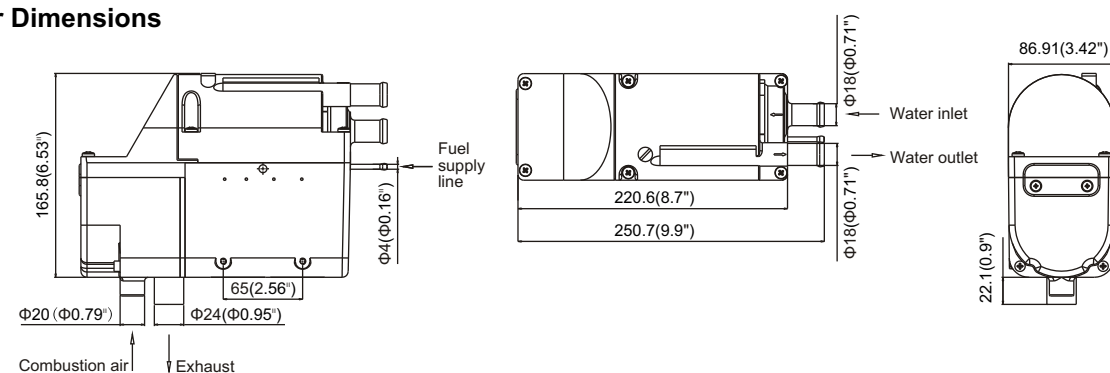

# WATER-HEATER FOR VEHICLES

• Technical description • Installation instructions • Operating instructions • Maintenance instructions



## Heater Installation Location and Position

The best place to install the water heater is in the engine compartment; the heater must be installed below minimum engine coolant level in order to allow the air to escape and fill up the heater with water or coolant when the bleed screw is open.

### ◆ Tolerable swivel range

Depending on the installation conditions, swivel angles should be as shown below.

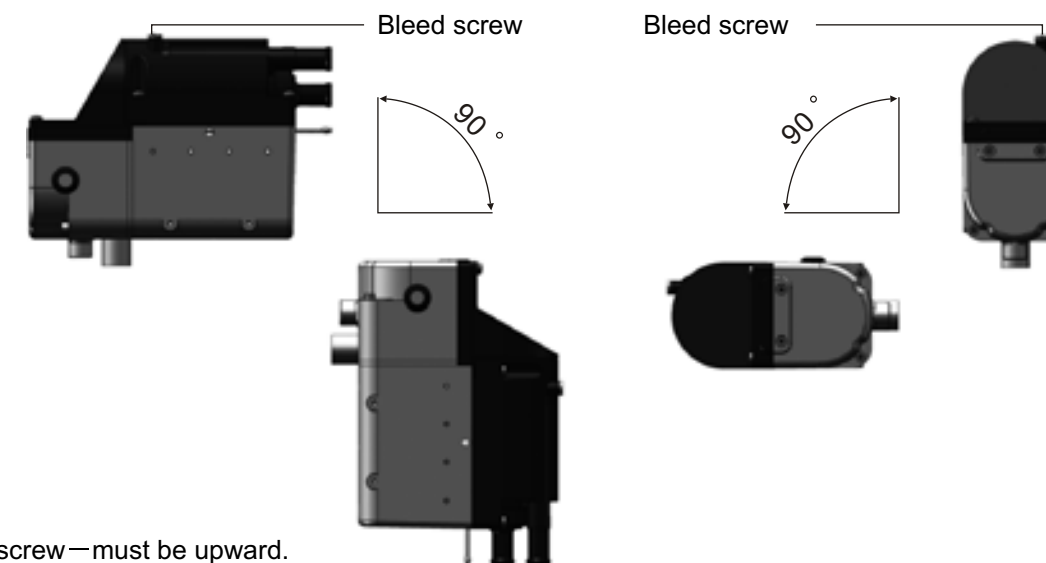

### Note:

The bleed screw—must be upward.

### ◆ Please note:

• In the heating mode, the heater can deviate from the shown normal or maximum installations positions by up to  $+15^\circ$  in all directions in order to accommodate the vehicle or boat movement.

## Engine cooling system and heater hose connection

### ◆ Hose Connection Diagram

Connect the heater between the engine and the cabin heater core as shown.

Cut water hose from the engine to the heater core, hook up the hose from engine to the inlet fitting of the heater (lower) and the other end of the hose (heater core side) into the heater outlet (upper).

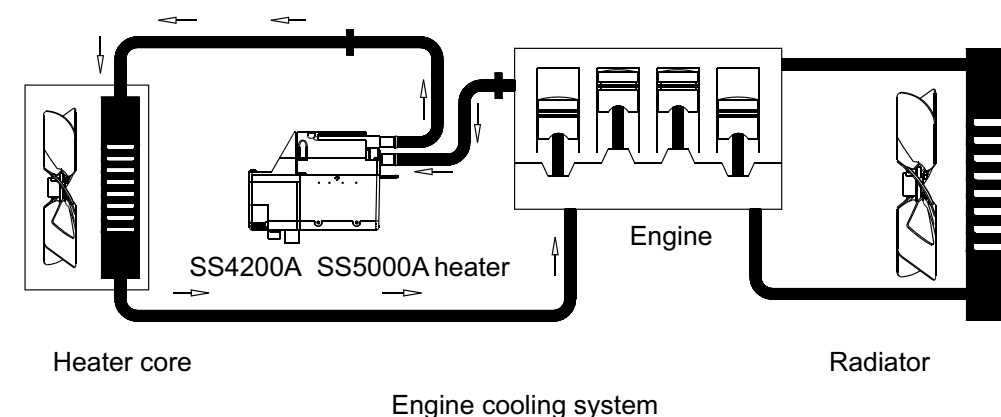



# WATER-HEATER FOR VEHICLES

• Technical description • Installation instructions • Operating instructions • Maintenance instructions

## ◆ Please note:

- Heaters hoses and the hot air outlet shall be routed and fastened in such a way that they pose no risk to people or temperature sensitive materials.
- Before working on the coolant circuit, turn OFF the heater and wait until all components have cooled down completely; always wear safety gloves and eye protection.
- Please take note of the direction of flow of coolant or water.
- Fill the heater and water hoses with coolant before connecting to the coolant circuit. Route the hoses in such a way as to avoid kinks, rubbing hoses against sharp corners, etc. Provide sufficient clearance to hot vehicle parts, and protect hoses from chafing and rubbing against vehicle body. Use protective heat shields if necessary.
- Secure all hoses with hose clips. After operating the heater for few hours check for leaks and tight clamps as necessary.
- Maximum cooling circuit pressure shall not exceed 15 PSI (1 bar).
- The coolant liquid must contain at least 10% antifreeze all year round as a corrosion protection.
- Before commissioning the heater or after changing the cooling liquid, the whole coolant circuit including heater must be free of air bubbles according to the installation instructions. To top off cooling system, use only coolants approved by vehicle manufacturer.

## Combustion air system

Install the tube of the combustion air intake in such a way that the air intake is protected from sucking water, dust, hot air, exhaust fumes or any other debris into the combustion chamber.

Inner hose diameter  $\Phi 3/4$  " (20 mm); max. Length 55" (1.5 m), depending on the installation conditions.

## Exhaust System

The flexible exhaust pipe inner diameter of  $\Phi 15/16$ " (24mm) can be shortened to no less than 8" (0.2m) from the heater to the silencer (muffler) but not longer than a total of 78" (2m) including muffler; fasten the exhaust silencer (muffler) at suitable position to the vehicle frame, route the flexible exhaust pipe from the heater to the exhaust silencer and fasten with hose clamps. Use hose clips to attach the exhaust flex pipe to the vehicle body.

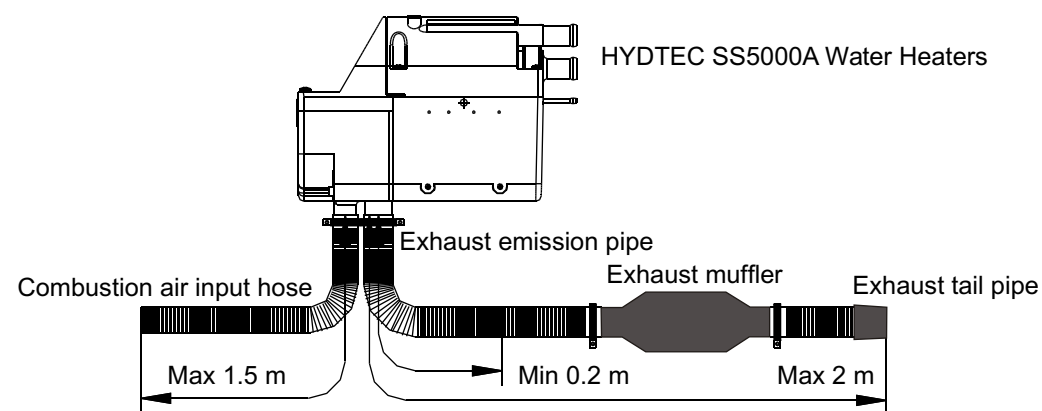

## ◆ Safety Instruction



### WARNING

- The entire exhaust system gets very hot during operation and immediately after the heater has been working. Keep the exhaust system parts away from any flammable materials; wires, hoses, fuel lines, carpets, plastics, brake lines, etc.



# WATER-HEATER FOR VEHICLES

• Technical description • Installation instructions • Operating instructions • Maintenance instructions

Maintain at least 1/2" air gap between the exhaust pipe and sheet metal walls in order to prevent the heat transferring through the metal and damaging materials on the other side of the wall. Use heat shields if necessary. Point the heater exhaust tail pipe slightly downward, in open air, away from travel direction and at least 12" away from any combustible or flammable materials.

Tail pipe cannot protrude beyond the lateral limits of the vehicle. Route the exhaust pipe in such a way so the exhaust fumes cannot be sucked into the vehicle.

Do not perform any work on the exhaust system while the heater is working. Before working on the exhaust system, first turn the OFF heater and wait until all parts have cooled down completely, always wear safety gloves and eye protection.

## Fuel Supply

### ◆ The following safety instructions must be observed when mounting the fuel pump, routing fuel lines and installing fuel tank pick-up tube

Turn OFF vehicle engine and heater before working on the fuel supply or before refueling. Do not use "naked" lights, open flames, do not smoke, do not inhale fuel vapors and avoid fuel contact with skin. Work only in well ventilated area.

When installing fuel lines, use only a sharp knife to cut fuel hoses and pipes. Interfaces shall not be crushed and must be free of burrs.

The fuel line from the pump to the heater should be installed at a continuous rise.

Fuel lines must be fastened to avoid damage and / or noise from vibrations.

Route the fuel lines in a way that they are protected from vehicle distortion, movement, etc. Never route or fasten fuel lines to the heater or vehicle exhaust system. When the fuel line crosses a hot element, always ensure there is sufficient clearance. If necessary, install heat deflection plates.

### ◆ Safety Instructions for fuel pipes and fuel tanks in passenger compartment

In a passenger bus fuel pipes and fuel tanks shall NOT be routed through the passenger compartment or operator or driver's cab.

Fuel tanks in passenger vehicles must be positioned in such a way that the exits are not in direct danger from a possible fire.

### ◆ Fuel supply for diesel heater

Mode 1: Fuel line installation using T connector

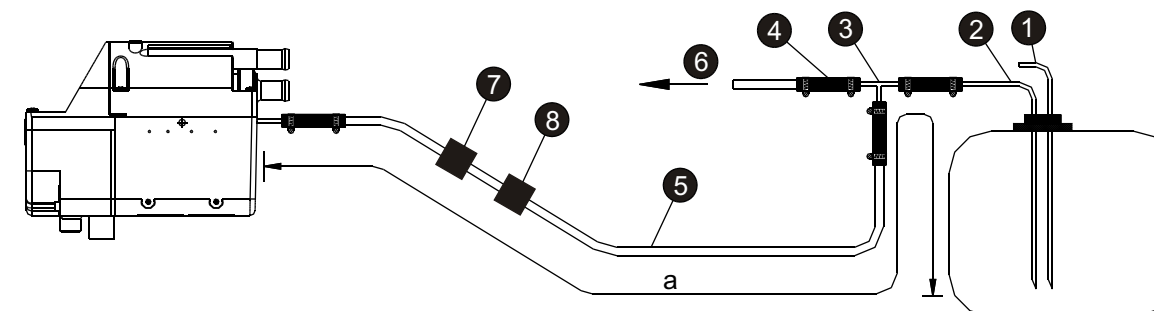

- |                              |                               |                                    |                 |
|------------------------------|-------------------------------|------------------------------------|-----------------|
| (1) Fuel return pipe         | (3) T fitting                 | (5) Fuel line max. length (5m) 15' | (7) Fuel pump   |
| (2) Fuel feed pipe from tank | (4) Fuel pipe connecting hose | (6) To engine                      | (8) Fuel filter |





# WATER-HEATER FOR VEHICLES

• Technical description • Installation instructions • Operating instructions • Maintenance instructions

## ◆ T fitting Setting Angle

Use the installation positions shown in the diagram when inserting a T fitting.

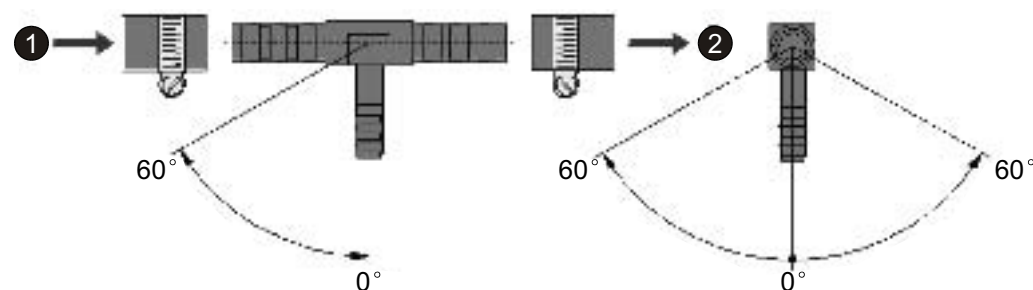

(1) Direction of flow from the fuel tank

(2) Direction of flow to vehicle engine

Mode 2: Fuel line installation with tank pick-up tube

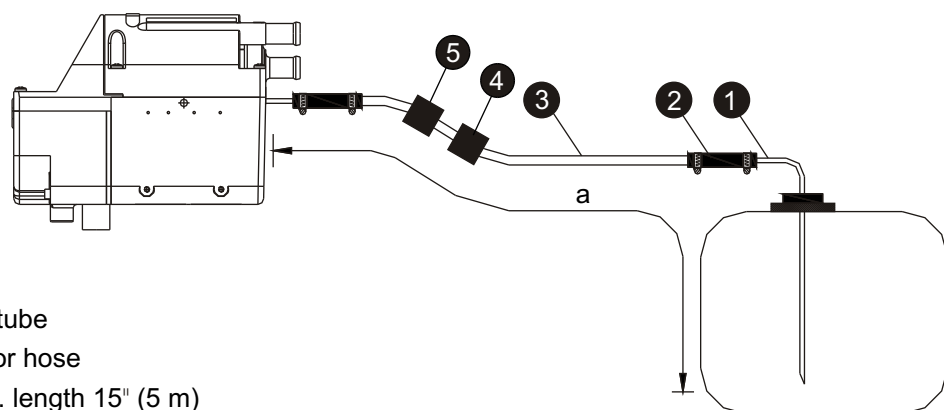

(1) Tank pick-up tube

(2) Fuel connector hose

(3) Fuel line max. length 15' (5 m)

(4) Fuel filter

(5) Fuel pump

## ◆ Max. suction and pressure height

Max. height from fuel tank to heater —a= 12' (3000 mm)

Max. suction height from bottom of tank —b= 3.9' (2000 mm)

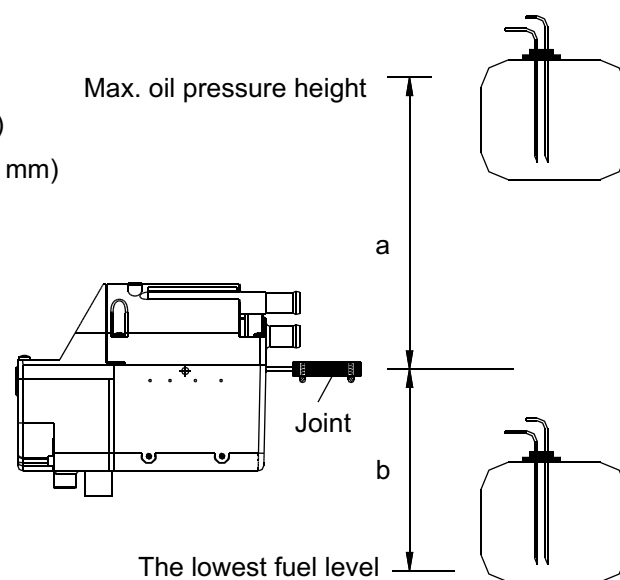

# WATER-HEATER FOR VEHICLES



• Technical description • Installation instructions • Operating instructions • Maintenance instructions

## ◆ Mounting of fuel intake system

### • Install method

Drill 31/32" (24mm) hole in appropriate location in top of fuel tank, as shown figure 1:

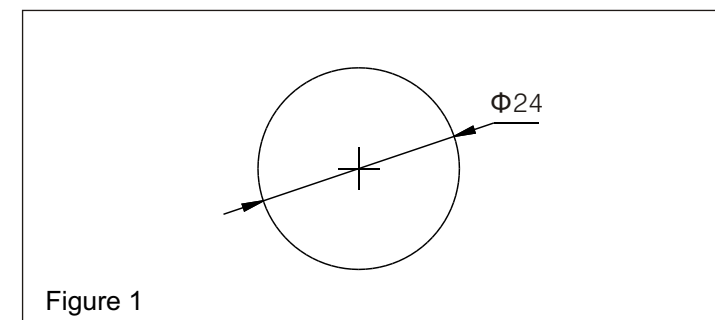

Mount the fuel intake system and fuel pump, as shown figure 2, 3

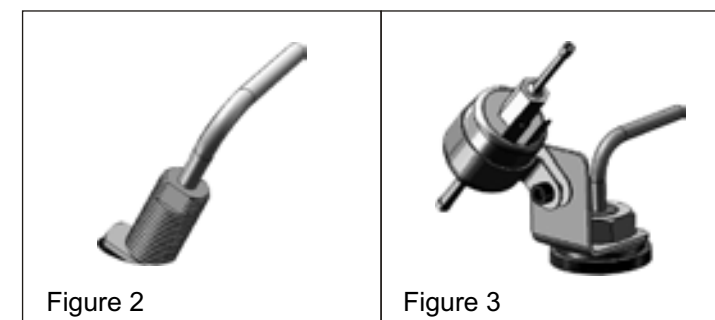

## ◆ Please note:

• When drilling into the fuel tank, take precautions to prevent possible sparks from electric tools (ground all tools). Prevent shavings and any other debris to fall into the fuel tank.

## Operating Instructions

Before starting the heater, perform a safety check: all components must be firmly fastened, check for fuel leaks, make sure the heater is filled with water or coolant (all air shall be bleed out). Bleed fuel line and prime fuel pump. To start the heater; turn the thermostat to "high" (turn the knob clockwise), push heat bottom, the blower motor will start running. After about 45 sec. the fuel pump will start pumping. If the fuel is not ignited in about 90 sec. (possible air in fuel line) the glow pin will shut down for about 1 min. and then it will start the process again. The process will repeat until there is no more air in fuel line.

Heater at high altitudes:

1. Heating at altitudes below 5,000' (1,500m), -unlimited heating possible.
2. Using heater at altitudes higher than 5,000' (1,500m) requires installing an altitude pressure sensor.

## Description of functions

### ◆ Operation



# WATER-HEATER FOR VEHICLES

- Technical description
- Installation instructions
- Operating instructions
- Maintenance instructions

When the heater is turned ON, the control lamp comes ON. The combustion air blower starts running, glow pin starts heating up, and fuel pump starts pumping fuel. Once the flame is stable, glow pin will turn off.

### ◆ Heating mode

Once the water reaches 175°F (85°C) the heat will turn OFF, the combustion fan and water pump will continue to operate on the low speed. The heat light will stay ON. The heater will restart after water temperature drop below setting point. After the heater is turned OFF the exhaust fan and water pump will run for approximate. 2 min. in order to evacuate exhaust fumes and cool off the combustion chamber.

## Controls and Safety Device

If the heater does not ignite within 90 seconds after starting the fuel pump, the process repeats several times. After several unsuccessful starting attempts the controller will lock the system in order to prevent fuel flooding the chamber. You can restart the process by switching the heater OFF and then ON.

If the flame goes off during operation, the heater will restart by itself. If the heater does not ignite after several attempts, the heater will lock and it will need to be turned OFF and ON manually.

In the case of overheating (for example, lack of water, poorly vented coolant circuit), the overheating sensor is triggered, the fuel supply is interrupted and the heater turns OFF. Once the overheating has been eliminated, the heater can be restarted manually by turning OFF and ON again. The heater will turn ON when the water temperature drops below 158°F (70°C). If the heater has been switched OFF and ON too many times, the controller will lock, wait for about 15 min. and turn the heater ON again.

If the lower or upper voltage limit is reached, the heater will turn OFF.

The heater does not start when the glow pin is defective or when the fuel pump power is interrupted.

The fan speed is continuously monitored. If the fan motor does not start or if the speed deviates by more than 40%, the heater will turn OFF after 60 sec.

The controller can be enabled again and it will flash fault code:

Use chart below to read the fault code list.

Do not switch the heater OFF and ON again more than twice.

### ◆ Please note:

Emergency shut down.

In event of an emergency, shut down the heater as follows:

- Try to turn the heater OFF with the control panel.
- Pull the fuse out.
- Disconnect battery power.

## Electrical system



### Safety Instruction for wiring the heater

- The Heater shall be connected to the power according to the EMC requirements. See instruction below;
- Ensure that the electric cable's insulation is not damaged. Avoid: chafing, kinking, jamming or exposure to heat.
- Seal all unused connector chambers with filler plugs to ensure there are not dirt enter into and water-proof.
- All electrical connection shall be free of corrosion and firmly connected.
- Lubricate all outside connections with contact grease.

# WATER-HEATER FOR VEHICLES



- Technical description
- Installation instructions
- Operating instructions
- Maintenance instructions

### ◆ Wire colors

Symbol	Color	Symbol	Color	Symbol	Color
SW	Black	Br	Brown	Ge	yellow
Or	Orange	Vi	Purple	Gn	Green
Rt	Red	Bl	Blue		

### ◆ Electrical Circuit Diagram

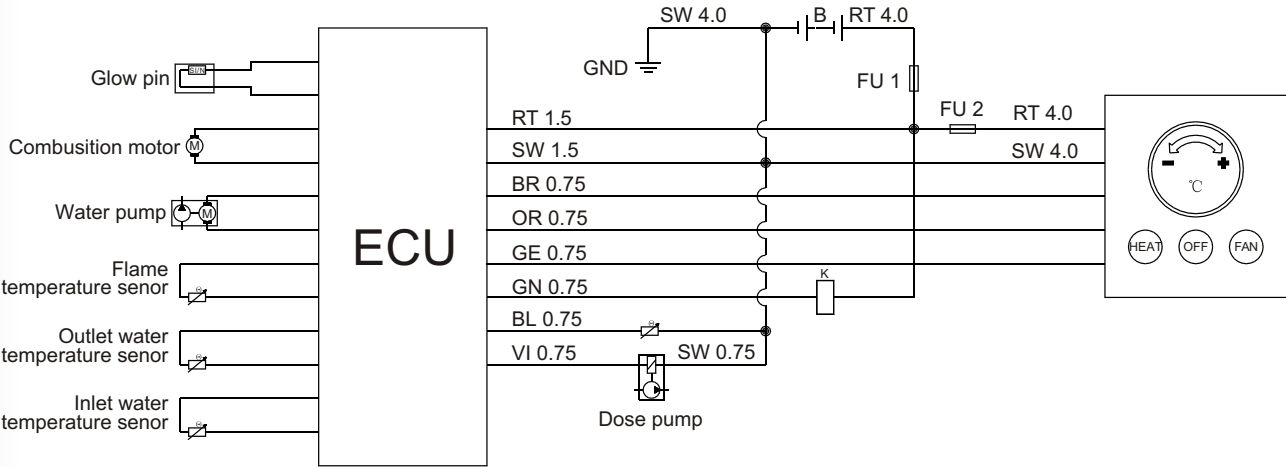

## Troubleshooting, Malfunctions and Maintenance

### ◆ Malfunction checklist

Heater does not start after being turned on; switch the heater OFF and ON again.

If the heater still does not start, check the following:

- is there fuel in the tank ?
- are fuses ok ?
- are electrical cables, all connections, etc OK ?
- is anything clogging the combustion air supply or exhaust system ?
- does the control panel flash the fault code ?



## ◆ Water heater fault code

Code flashing times	Description	Solution
1 Time	The power supply voltage too high	Check the voltage, possible alternator drive belt too loose, check charging system
2 Times	The power supply voltage too low	Check the voltage, charge battery, check charging system
3 Times	The burner temperature abnormal	Check the temperature sensor connection and position whether it is correct Check the temperature sensor wires for possible damage or short
4 Times	Inlet water temperature sensor abnormal	
5 Times	Outlet water temperature sensor abnormal	
6 Times	Glow pin malfunction	Check the voltage between glow pin terminals it should read 12 or 24 V Check for broken wires and loose connection, short out wires Remove and check the glow pin for any visible damage; replace glow pin if damaged
7 Times	Fuel pump malfunction	Check voltage at fuel pump it should pulsing 12V / 24V Check wires for damage, check connections and shorted circuits Check fuel pump for any damage
8 Times	Blower malfunction	Check blower wires for damage and proper connections Check blower for any visible damage
9 Times	Water pump malfunction	Check wiring connections Check water pump for debris Check for cramped/collapsed hoses
10 Times	Lgnite failed or flame extinguish protection	Check if there is fuel in tank Check all fuel line connections Check fuel pump if it is working Check the glow pin if it is working normally Check the air inlet/exhaust if it's not blocked
11 Times	Burner overheating protection	Check the fuel pump pressure Defective fuel injector Check water flow Check overheat sensor
12 Times	Outlet warm water temperature overheating protection	Check water level Bleed water system Check water flow Check warm water temp, Sensor
13 Times	Flame extinguished or burner overheating forbids the system operation	Check fuel pressure Check overheat temp, sensor Check water flow Disconnection power and re-connection again
14 Times	Communication fault	Check all wire connection.



To resets the system press down “OFF” button→waiting for 15 minutes, it should clear the fault codes, turn ON the system. If the system does not clear the code, disconnect battery power, wait few minutes, hook up the battery power and turn the system ON.

## ◆ Maintenance Instructions

Switch the heater ON once a month for about 10 minutes, even if there is no need for heat.

Check the opening of the combustion air supply and the exhaust system after longer standstill periods; clean if necessary.

Before the heating period starts the heater should undergo a trial run. If persistent extreme smoke, unusual burning noises, or an unburned fuel smell develop or if electric /electronic parts heats up, the heater shall be switched OFF immediately. Remove fuse or disconnect battery power.

Have the heater checked by authorized, trained service technician.

At least once a year have the heater checked by authorized, trained service technician. Remove glow pin and atomizer; clean the screen and the atomizer chamber with wire brush, if notice that there is excessive carbon build up the entire combustion chamber shall be cleaned out.

## ◆ Please note

- The warranty claims will become void if the heater is repaired or serviced by an unauthorized person.

## ◆ Explain

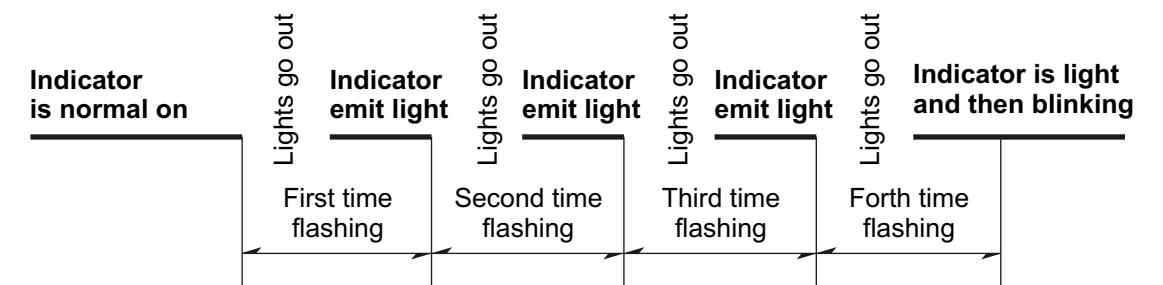

**Instruction:** one time flashing is point to the light on to light out the illustrations show forth time flashing, it mean there are sensor abnormal from the above form show like that.





## Heater assembly SS4200A and SS5000A

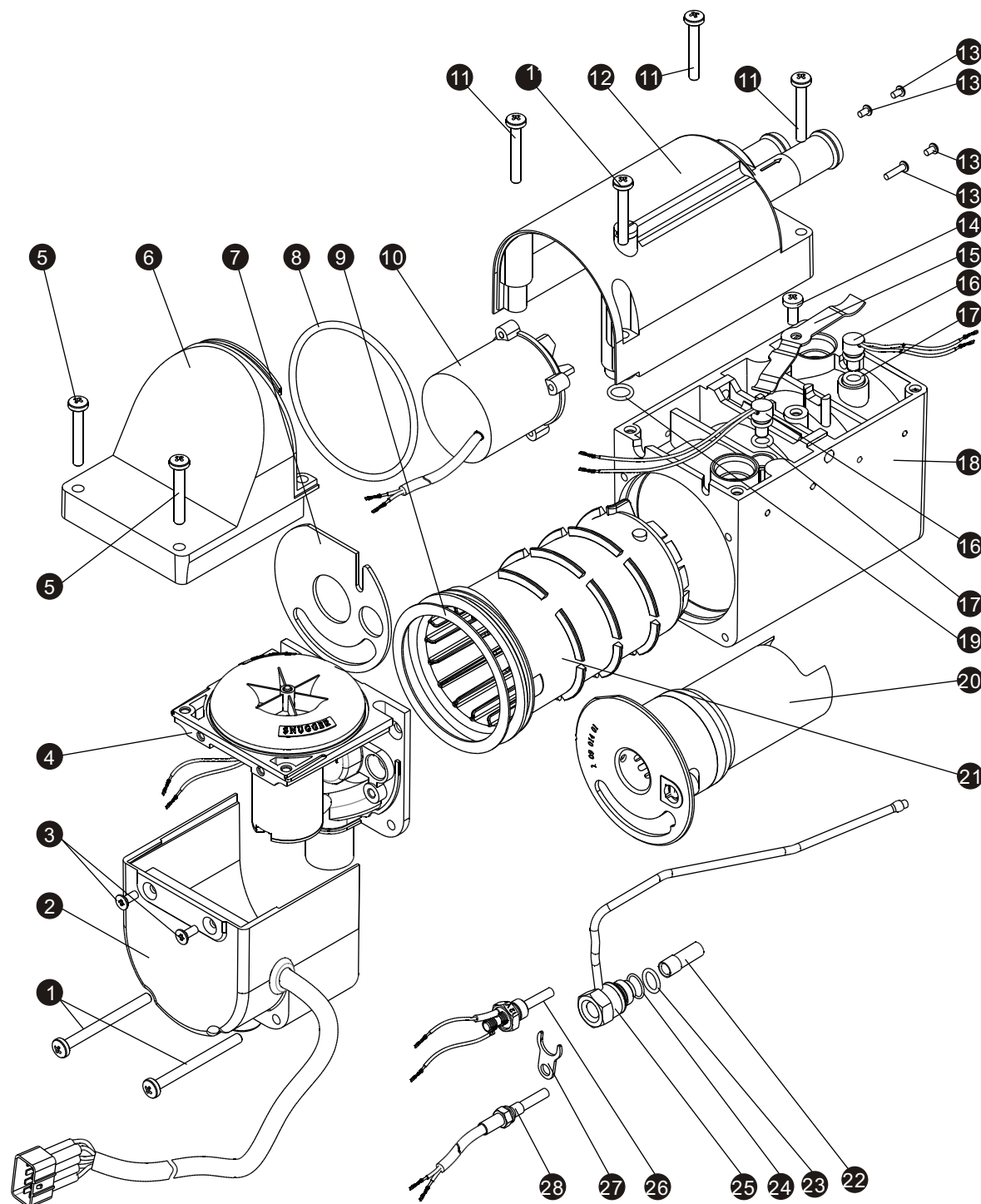

## Parts list of the SS4200A and SS5000A

Item #	QTY	Part #	Description
1	2	• 425065	• Hex screw
2	1	• 42016	• Outer cover / control unit
3	2	• 42010	• Flat head Philips screw
4	1	• 42014	• Intake and exhaust assembly
5	2	• 425025	• Hex screw
6	1	• 42071	• Outer cover and blower fan cover 1
7	1	• 42031	• Gasket 1
8	1	• 42022	• O ring 1
9	1	• 42030	• Gasket 2
10	1	• 42008A/B	• Cooling pump
11	2	• 425035	• Hex screw
12	1	• 42072	• Outer cover and blower fan cover 2
13	4	• 42035	• Mounting screw, water pump
14	1	• 425012	• Hex screw
15	1	• 42013	• Flat spring
16	2	• 42036	• Temperature sensor
17	2	• 42026	• O ring temp. Sensor
18	1	• 42009	• Casing
19	2	• 42024	• O ring 3
20	1	• 42015	• Burners Assembly
21	1	• 42028	• Heat exchanger
22	1	• 42012	• Atomizer
23	1	• 42023	• O ring 2
24	1	• 42025	• O ring 4
25	1	• 42027	• Connected socket
26	1	• 42001A/B	• Glow pin assembly
27	1	• 42034	• Spring washer
28	1	• 42011	• Flame sensor



## WATER-HEATER FOR VEHICLES

• Technical description • Installation instructions • Operating instructions • Maintenance instructions

### Installation components diagram HYDTEC® SS4200A / SS5000A

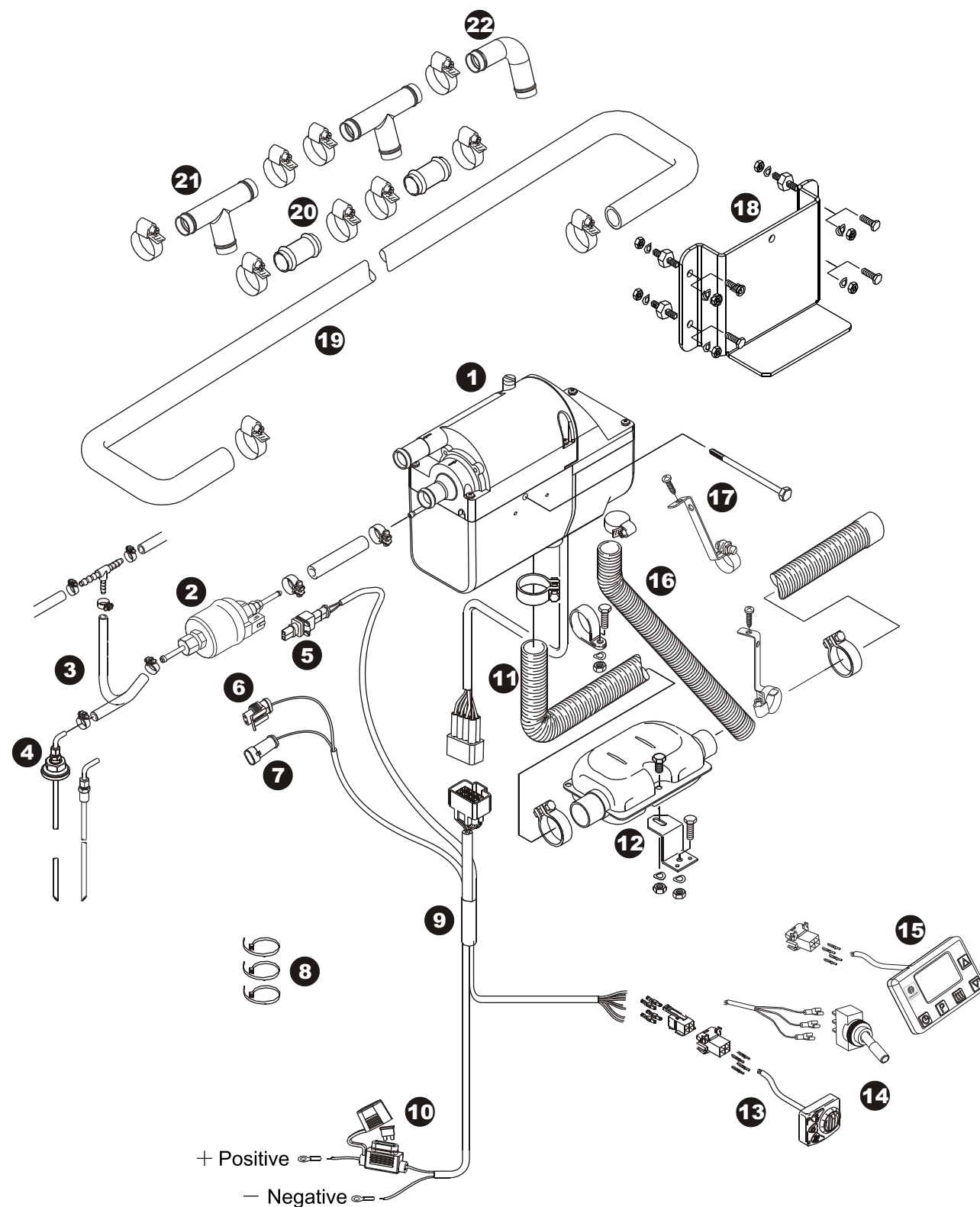

## WATER-HEATER FOR VEHICLES

• Technical description • Installation instructions • Operating instructions • Maintenance instructions



### Components list of the Water Heater

Item	Part #	Description	Qty
1	• 4200A	• Water heater	1
2	• 2301A/B	• Fuel pump	1
3	• 230406	• Fuel pipe $\phi$ 4.5X3 mm	1m
4	• 230700	• Fuel pickup tube assembly	1
5	• 42503	• Fuel pump control wire harness	1
6	• 42451	• Fan control wire harness	1
7	• 42452	• Fan sensor	1
8	• 230411	• Cable ties	25
9	• 42501	• heater wire harness	1
10	• 230601	• Fuse 24V/15A (12V/20A)	1
11	• 42055	• Air inlet pipe	1
12	• 42037	• Exhaust silencer	1
13	• 42046	• Mini control panel	1
14	• 230610	• ON/OFF switch	1
15	• 230620	• 7 day digital controller	1
16	• 230409	• Exhaust pipe	1
17	• 230707	• Hanging brackets	2
18	• 42040	• Heater bracket	1
19	• 42052	• Water hose	3m
20	• 42401	• Straight barb fitting	2
21	• 42403	• T barb fitting	2
22	• 42402	• 90deg. barb fitting	2